

Marketing Preview



14 High View, Sheffield, S5 8YE

£1,200 Per Month

Bedrooms 3, Bathrooms 1, Reception Rooms 1



A beautifully renovated three-bedroom home, ready to move into now. This stylish property has been finished to a high standard throughout, offering modern interiors, spacious living areas, and a fresh, contemporary feel. Perfect for families or professionals, it combines comfort and practicality in a convenient location. Available immediately – don't miss the opportunity to make this your next home.

PLEASE NOTE THAT THE LOG BURNER IS STRICTLY FOR ORNAMENTAL USE ONLY AND HAS BEEN CAPPED OFF.

A fantastic opportunity to rent this modern three-bedroom semi-detached home, ideally tucked away in a quiet cul-de-sac. Beautifully presented throughout with a stylish high-gloss kitchen, the property also benefits from off-road parking, an enclosed garden with views, and excellent access to the City Centre and M1 motorway. A perfect family home.

Ground Floor

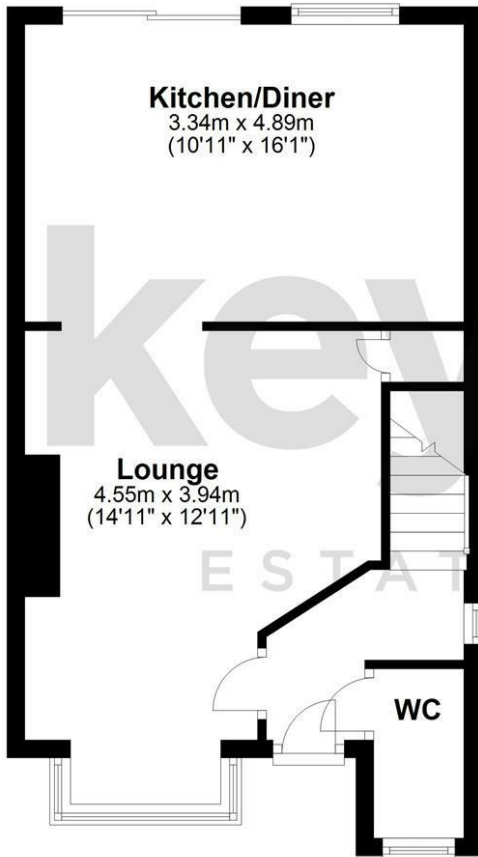

First Floor

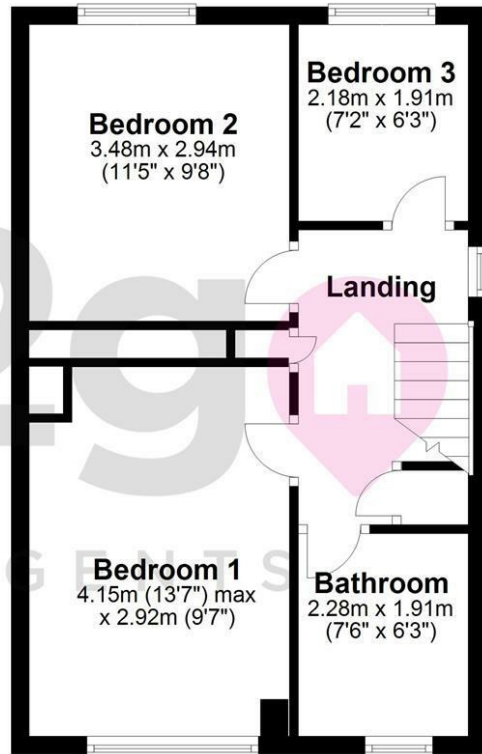

Total area: approx. 81.0 sq. metres (871.9 sq. feet)

Energy Efficiency Rating		
	Current	Potential
Very energy efficient - lower running costs		
(92 plus) A		
(81-91) B		83
(69-80) C		
(55-68) D	66	
(39-54) E		
(21-38) F		
(1-20) G		
Not energy efficient - higher running costs		
England & Wales	EU Directive 2002/91/EC	

